

PRODUCT INFO

Adjustable parallel clamp mountings VGP are made of drawn aluminum profiles and have a slitted clamping point machined by cutting methods.

Adjustable parallel clamp mountings are used for fine adjustments of measuring or test setups.

For coarse adjustments in millimeters, two adjacent clamping points are released so that the rod can be shifted quickly. When using retaining rods / retaining tubes RK in type LS with longitudinal scale, their scale provides orientation during presetting.

For fine adjustments, two diagonally opposite clamping points are released. The relative position of the retaining rods/retaining tubes can then be set with the adjusting wheel. The adjusting distance can be read in 0.1 mm increments based on the knurled graduations. Due to the integrated spring, the adjustment is free of backlash.

RoHS-compliant product

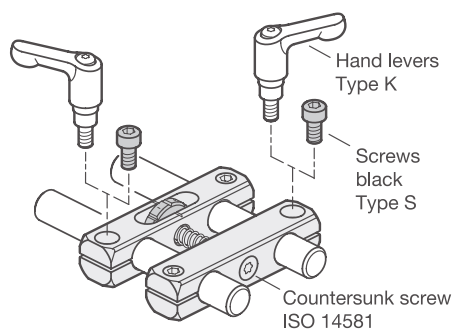
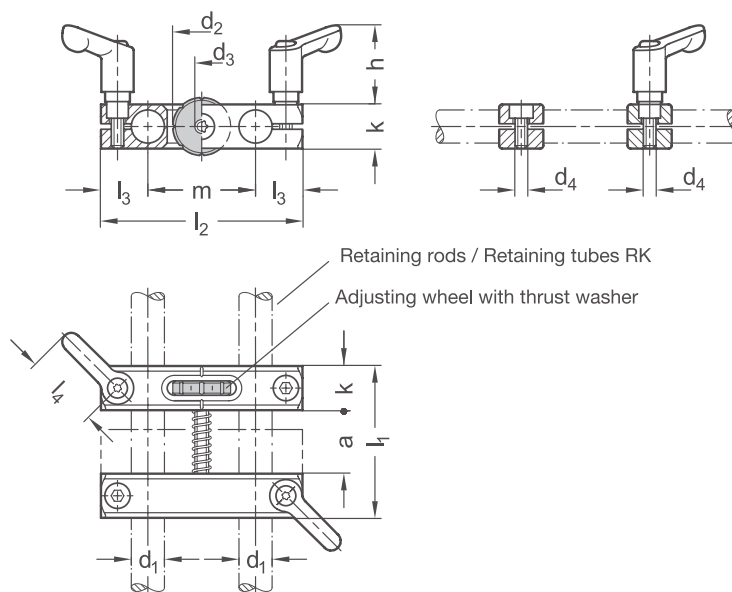

Application example

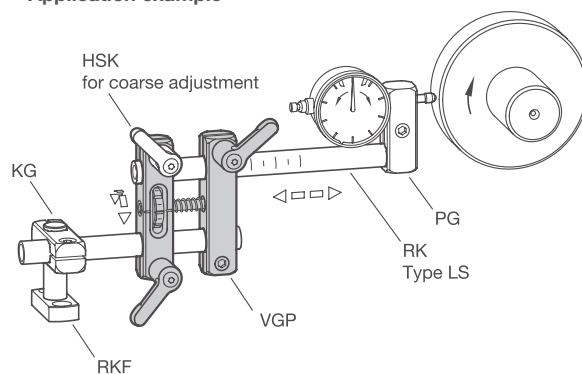

Clamping points											
Bore d₁	Stroke max. a	d₂	d₃	d₄	h	k	max. l₁	l₂	l₃	l₄	m
B 8	12	19	M 4	M 4	23,5	14	40	59	13,5	22	32
B 12	18	21	M 5	M 5	32	16	50	73	17	30	39
B 16	24	26	M 6	M 5	35	20	64	91	20,5	45	50

Screw points z	
2	With hex socket cap screws stainless steel DIN 912-A2-70 two pieces blank and two pieces chemically blackened
8	With two adjustable hand levers, lever zinc-die-cast textured powder-coated, Silver RAL 9006 and two hex socket cap screws stainless steel

Surface o	
G	Tumbled, matt
S	Anodized black

Assembly variants
As delivered

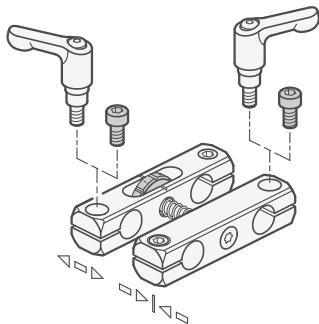

Clamping points inverted	Movable clamp mounting, angular and clamping point inverted	Fixed clamp mounting, angular and clamping point inverted

ORDER KEY

VGP - d₁ - z - o

Parallel clamp mounting

Clamping points

Screw points

Surface

ACCESSORIES

– Retaining tubes **RK** see catalog page 178

– Adjustable hand lever set **HK** see catalog page 172

2D
2C
2B
2A
1D
1C
1B
1A